

Chippenham ↑ Swindon/Marlborough ↑

Swindon/Marlborough ↑

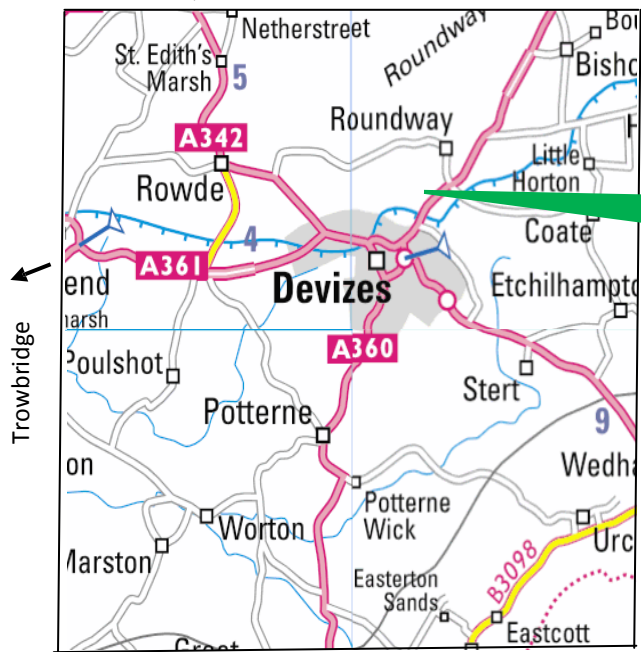

Andover / Pewsey ↘

Salisbury ↓



Devizes ↓

Community First

Unit C2,
Beacon Business Centre,
Hopton Park, Devizes,
SN10 2EY

Tel 01380 722475

Please note: Certain Sat Navs when using the postcode will direct you to the office on the A361 only. There is no access to the office directly from the A361. Access is from Hopton Road only.

Directions to Community First

Community First is situated on the outskirts of the town at Hopton Park on the A361 signposted towards Swindon/Marlborough.

From Salisbury

From the Salisbury direction (A360) having passed the Southgate Inn on your left hand side, turn right at the mini roundabout as you enter the town following the 'All routes' sign. Drive straight ahead at the next mini roundabout and go past the fire station on your right-hand side. At the double roundabout at Kwik Fit: at the first roundabout get into the right hand lane but take the first exit. At the second roundabout take the second exit heading towards Marlborough (signposted Swindon and Marlborough). Drive straight ahead at the next two mini roundabouts. At the second mini roundabout by the Church follow the sign saying 'Hopton & Garden Industrial Estates.' Go onto London Road and past the Police Headquarters on your left. At the second large roundabout you come to (B&Q on your right) take the first exit into Hopton Industrial Estate. Follow this road past Hayden's Bakeries, and the Recycling Centre. After Cross Engineering turn right towards Route 2 Fitness (signposted St. John Ambulance). Follow the road around to the right. Community First is located between the St John Ambulance and Wiltshire Council Offices. Please note **Parking info.** below.

From Swindon/Marlborough

If you are coming from the Swindon/Marlborough direction (A361) as you come into the outskirts of the town there is a short section of dual carriageway, Hopton Park Industrial Estate is signposted off to the right just after the dual carriage way has reduced to one lane. Turn right into Waller Road. MacQueen Veterinary Centre is on the corner opposite you. At the end of Waller Road turn left into Hopton Road (signposted Household Recycling Centre). Approximately 100m turn left into Beacon Business Park past Route 2 Fitness on your left hand side. (signposted St. John Ambulance). Follow the road round to the right. Community First is located between the St John Ambulance and Wiltshire Council Offices. Please note **Parking info.** below.

From Pewsey/Andover

If you are coming from the Pewsey/Andover direction on the A342, you will enter the town past the Fox and Hounds pub. At the second of the roundabouts you come to turn right following the Swindon / Hopton & Garden Industrial Estates signs. Go straight ahead at the next roundabout and again at the one after that (again following the Swindon / Hopton & Garden Ind. Estates signs.) At the large roundabout you come to take the second exit (again signposted Hopton Ind. Est.) . At the next roundabout (B&Q on your right) take the first exit into Hopton Industrial Estate (Hopton Road.) Follow this road past Hayden's Bakeries and Devizes Building Supplies and the Recycling Centre. After Cross Engineering (South Site) turn right as if you were going into Route 2 Fitness (signposted St. John Ambulance). Follow the road around to the right. Community First is located between the St John Ambulance and Wiltshire Council Offices. Please note **Parking info.** below.

From Chippenham/Melksham/Trowbridge

If you are coming from either the Chippenham or Melksham/Trowbridge direction, head towards Devizes Town Centre. At the Northgate roundabout (near Wadworth's Brewery) follow Through Traffic sign and turn left into New Park Street. Follow this road to the next roundabout and turn left again. Go straight ahead at the mini roundabout at Sainsbury's. At the next roundabout (Kwik Fit opposite) bear left following signs to Swindon and Marlborough. Drive straight ahead at the next two mini roundabouts. At the second mini roundabout by the Church follow the sign saying 'Hopton & Garden Industrial Estates.' Go onto London Road and past the Police Headquarters on your left. At the second large roundabout you come to (B&Q on your right) take the first exit into Hopton Industrial Estate. Follow this road past Hayden's Bakeries, and the Recycling Centre. After Cross Engineering turn right towards Route 2 Fitness (signposted St. John Ambulance). Follow the road around to the right. Community First is located between the St John Ambulance and Wiltshire Council Offices. Please note **Parking info.** below.

Parking info. Please note parking at the office is limited, see next sheet for available parking. THANK YOU

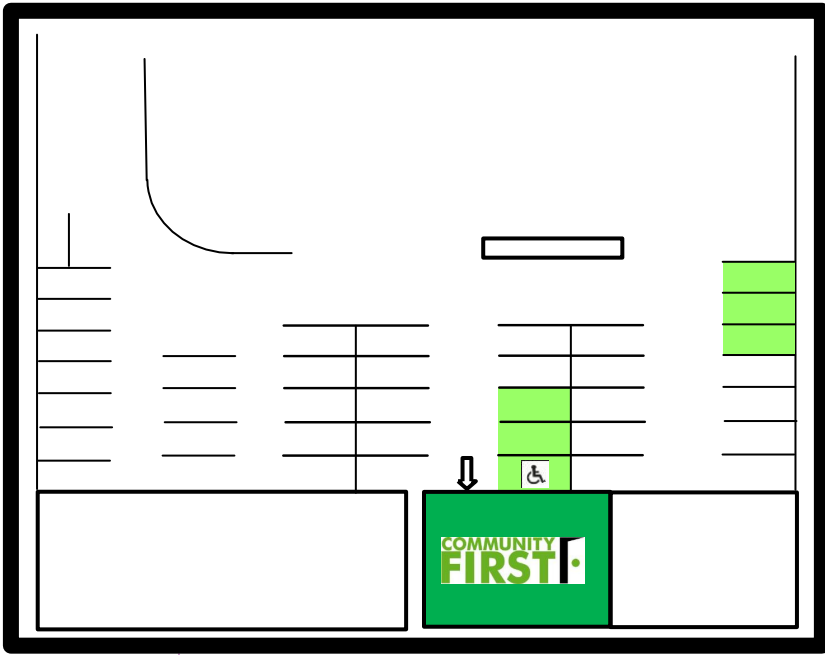

SERGEANT ROGERS WAY

Coral Cove
(children's soft play centre)

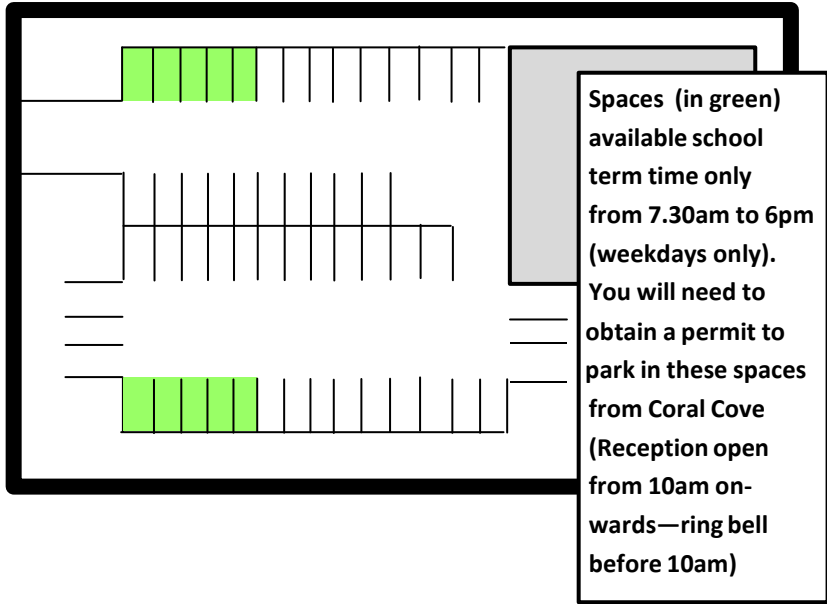

Spaces (in green) available school term time only from 7.30am to 6pm (weekdays only). You will need to obtain a permit to park in these spaces from Coral Cove (Reception open from 10am onwards—ring bell before 10am)

HOPTON ROAD

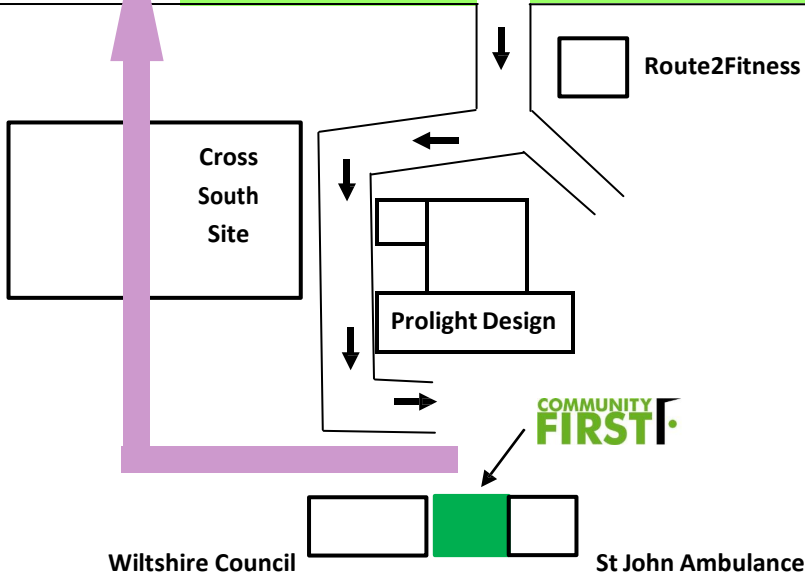

PARKING : There is limited parking around our offices. Directly in front of the office there are six spaces. (see dia top left - green spaces only). During **school term time, only on weekdays** you can park between 7.30am and 6pm at one of 10 allocated spaces at Coral Cove (children's soft play centre) in Sergeant Rogers Way (see dia top right—green spaces only). **Please obtain a parking permit from Coral Cove if you wish to park here.** Otherwise please park on Hopton Road.

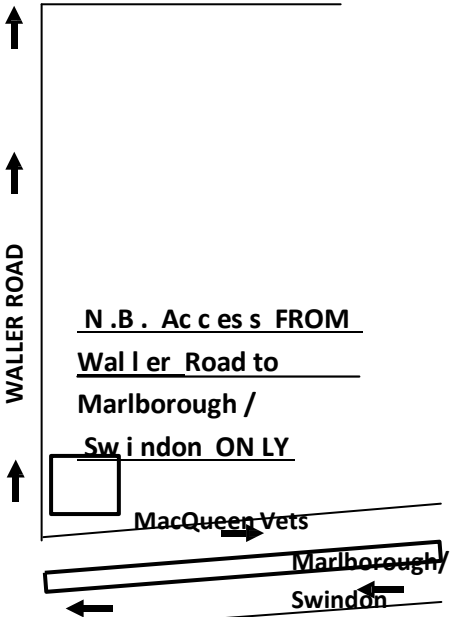
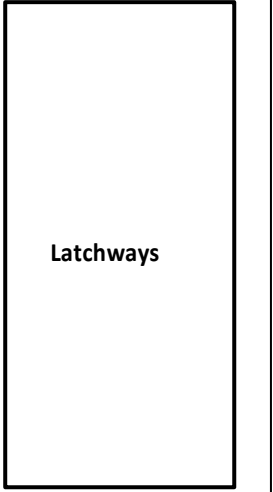

N.B. Access FROM Waller Road to Marlborough / Swindon ONLY

Devises